



CENTURION
MEDICAL PRODUCTS

GENERAL USE

CUHG1-INT

Remove Compass UniversalHg from its sterile package.

Remove the proximal luer cap.

For compartment pressure measurement:

Attach the distal end of the device to an 18 gauge needle.

The proximal end of the device can be attached to any syringe containing sterile saline.

Prime the device with saline. Then, holding the device at the angle of insertion, depress the blue power button on the side until it reads '00 mm' (Figure 1).

Insert the needle into the tissue until the compartment is reached.

Depress the syringe and inject roughly 0.3 cc of saline to make sure there's no subcutaneous tissue blocking the tip. After the saline is infused, simply read the compartment pressure.

For other applications:

Activate and calibrate Compass UniversalHg by depressing the blue power button for approximately one second until the LCD reads '00 mm' (Figure 1).

Activate and calibrate Compass UniversalHg prior to attaching accessories to avoid incorrect baseline pressure.

Depending on the application, attach an accessory (e.g. flushing syringe, stopcock, extension or IV tubing) to the proximal female luer lock port of the Compass UniversalHg (Figure 2).

Depending on the application, connect the distal male luer lock end of Compass UniversalHg to an accessory (e.g. needle, distal lumen of a central line, extension set or needleless valve in contact with the patient) (Figure 3).

Pressure is displayed on the Compass UniversalHg LCD (Figure 4).

If the procedure warrants, insert the guidewire (up to 0.096 cm diameter) through the Compass UniversalHg guidewire port and into the vessel (Figure 5). Smaller guidewires may necessitate the use of the guidewire insertion tool accompanying the guidewire holder.

Device power off and recalibration:

Press the button three times in a 'PUSH – PUSH – HOLD' sequence (i.e. quickly push the button twice and then hold the third button-push until the device turns off). To recalibrate and zero the device, open the device to atmosphere and depress the power button until the display reads '00 mm'.

For complete instructions and warnings, consult the IFU supplied with the device.

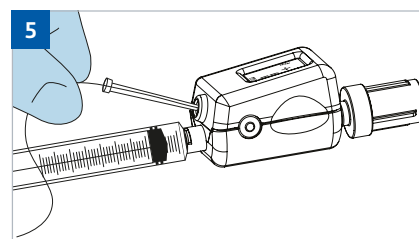
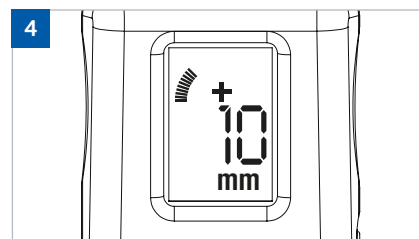
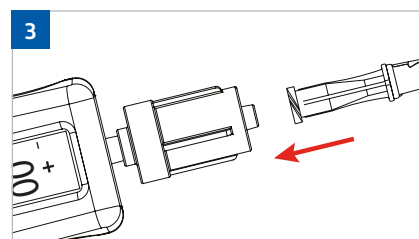
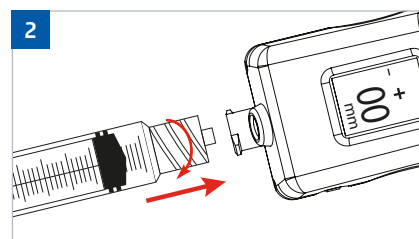
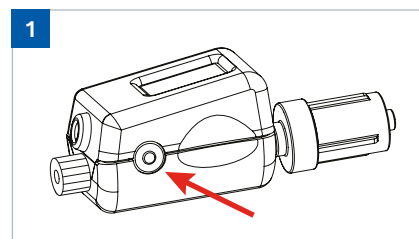

Medline Industries Ltd
3rd Floor
Quayside Wilderspool Business Park
Greenalls Avenue
Warrington WA4 6HL
United Kingdom
Tel.: +44 844 334 5237
Fax: +44 844 334 5238
www.medline.eu/uk
uk-customerservice@medline.com