



CVP FOR SEPSIS MANAGEMENT CUHG1-INT

Remove Compass UniversalHg from its sterile package.

Activate and calibrate Compass UniversalHg by depressing the power button for approximately one second until display reads '00 mm' (Figure 1).

Warning: Activate and calibrate Compass UniversalHg prior to attaching it to accessories to avoid incorrect baseline pressure.

Remove the proximal luer cap. Removing this cap prior to calibration does not affect the reading. Prime Compass UniversalHg with saline and attach Compass UniversalHg to the distal hub of the central venous catheter (Figure 2).

Position Compass UniversalHg at midaxillary line or phlebostatic axis, depending on the inclination of the patient, and then measure central venous pressure. Pressure is displayed on Compass UniversalHg LCD (Figure 3).

If extension tubing (sold separately) is needed to reach phlebostatic axis, attach Compass UniversalHg to the extension tubing, and then prime it prior to attaching it to the distal hub of the central venous catheter.

For continuous or intermittent pressure reading, the female luer lock port of Compass UniversalHg can be capped with a sterile needle-less valve connector or sterile cap.

Note: If Compass UniversalHg is capped, flush to ensure patency before CVP measurement.

For intermittent CVP reading with fluid infusion, the female luer lock port of Compass UniversalHg can be connected to fluid infusion tubing (Figure 4). When a pressure reading is needed, close the roller clamp (slide or other style clamp) prior to taking the reading (Figure 5).

Note: When the roller clamp is open during fluid infusion, the Compass UniversalHg will report the pressure of the infusion fluid, NOT the central venous pressure (Figure 6).

Device Power Off and Recalibration

Press the button three times in a 'PUSH - PUSH - HOLD' sequence (i.e. quickly push the button twice and then hold the third button-push until the device turns off). To recalibrate and zero the device, open the device to atmosphere and depress the power button until the display reads '00 mm'.

For complete instructions and warnings, consult the IFU supplied with the device.

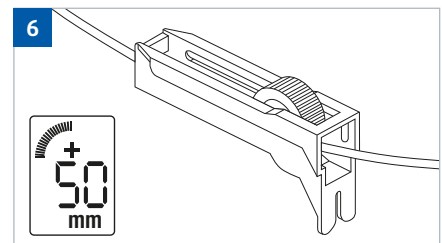
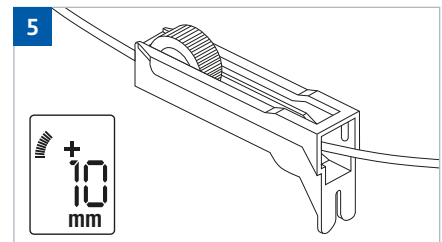
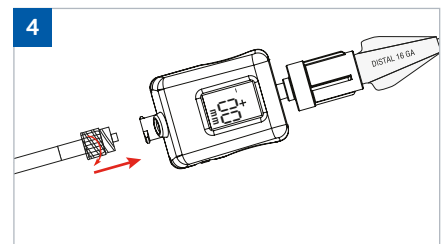
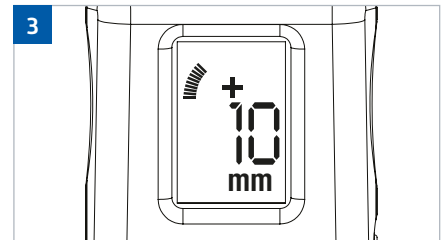
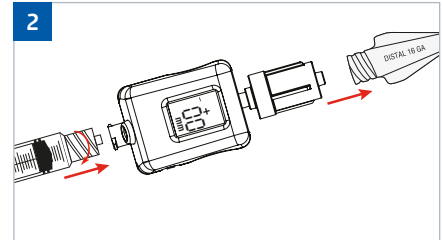
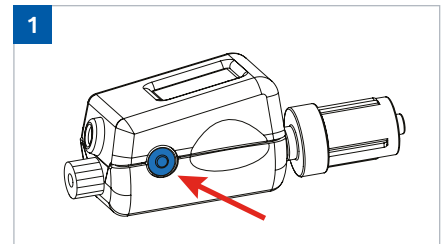

**ALWAYS
ON.**

Medline Industries Ltd
3rd Floor
Quayside Wilderspool Business Park
Greenalls Avenue
Warrington WA4 6HL
United Kingdom
Tel.: +44 844 334 5237
Fax: +44 844 334 5238
www.medline.eu/uk
uk-customerservice@medline.com